

S:\Engineering\Traffic\RAFT\Projects\Current\Projects\RoadwayStandards\TAR Standard drawings\Standard Drawings Revised 1.1.10\dwgs\ P100.dwg

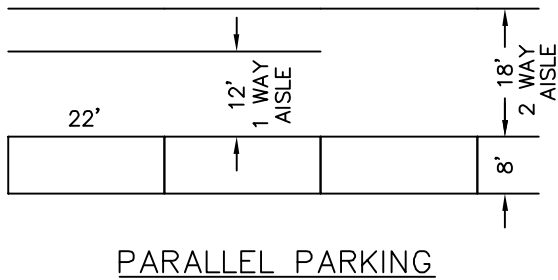

PARALLEL PARKING

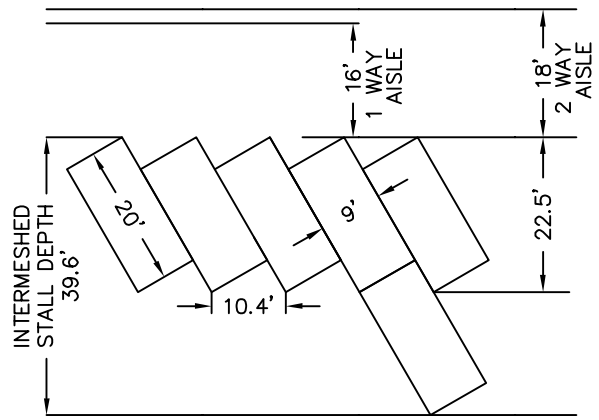

60° PARKING  
STANDARD STALL (9'x20')

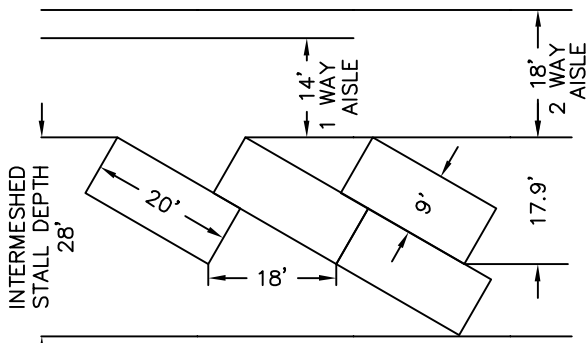

30° PARKING  
STANDARD STALL (9'x20')

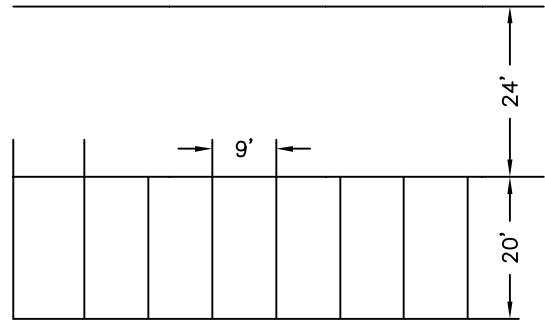

90° PARKING  
STANDARD STALL (9'x20')

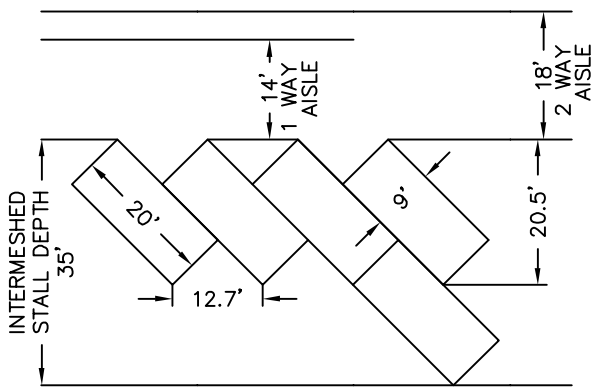

45° PARKING  
STANDARD STALL (9'x20')

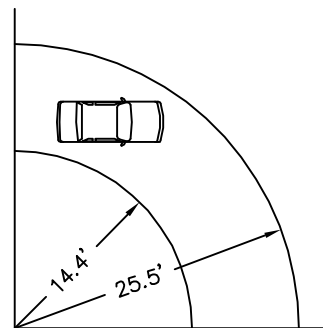

MINIMUM TURNING RADIUS

NOTES

1. SIDEWALK ADJACENT TO PARKING SHALL BE A MINIMUM OF 7 FEET WIDE IF VEHICLE OVERHANG WOULD DIMINISH SIDEWALK WIDTH.
2. DRIVE AISLES LESS THAN 20 FEET WIDE SHALL HAVE A MINIMUM 20' CLEAR ZONE BETWEEN VERTICAL OBSTRUCTIONS IF AISLE MAY RECEIVE NON PASSENGER VEHICLE TRAFFIC IN ORDER TO PROVIDE FOR EMERGENCY ACCESS AND TRUCK TRAFFIC.
3. REFER TO ZDO SUBSECTION 1007.07.D FOR COMPACT AND STRUCTURED PARKING ALTERNATIVES.

REVISION	DATE	BY

DEPARTMENT OF TRANSPORTATION  
AND DEVELOPMENT  
150 BEAVERCREEK ROAD  
OREGON CITY, OR 97045



APPROVAL DATE: 1/1/10

SCALE: N.T.S.

**PARKING AND AISLE  
LAYOUT DETAILS**

STANDARD  
DRAWING  
**P100**